

Model: CS21



APPLICATION:
 Multi-cell scales

CAPACITY RANGE:
 750kg - 1000kg - 1500kg

MATERIAL:
 Plated steel

ENVIRONMENTAL PROTECTION:
 IP67

APPROVALS:
 According to OIML - R60

CHARACTERISTICS
 Construction using special steel.
 High quality protection barrier using special silicones.
 Mounting compatibility.

APPLICATIONS
 CS21 model is manufactured to maintain its performance capabilities in the environmental conditions existing in industries, where tasks and cleaning demand a good environmental protection.

OPTIONS
 Consult for special requirements.

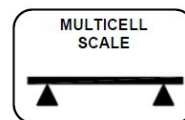

TEFLÓN® protects all the internal cables

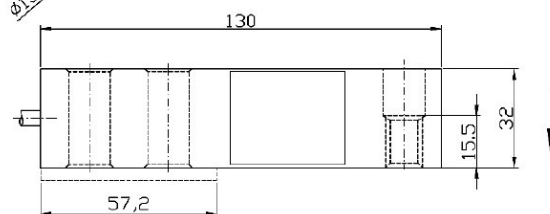
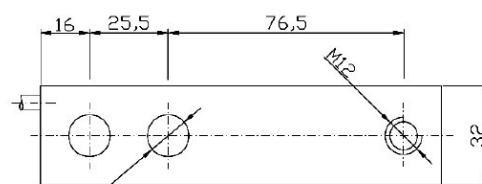

Dimensions in mm

