

# Model: CL-8

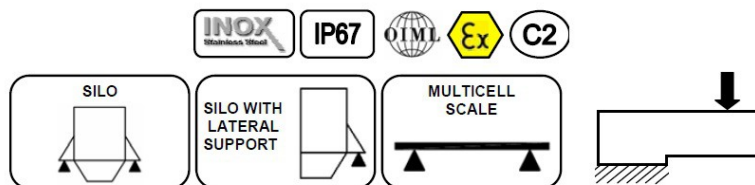

## APPLICATION:

High capacity and silos

## CAPACITY RANGE:

100kg - 200kg - 500kg - 1t - 2t

## MATERIAL:

Stainless steel

## ENVIRONMENTAL PROTECTION:

IP67

## APPROVALS:

According to OIML - R60

## CHARACTERISTICS

Manufactured in stainless steel with IP67 protection.  
 Mounting Kit in Stainless Steel or Zinc Steel.  
 Hostile environmental cable. Mounting compatibility.

## APPLICATIONS

The CL-8 Model it's manufactured to maintain its characteristics in external environments. This model is applied to control silos of high capacity & replaces level indicators with more accuracy and reliability.

## OPTIONS

Length of the cable is optional.

-10 to 100 °C temperature tolerance.

ATEX option EC-Type examination certificate  
 CEC 11 ATEX 040 X according directive 94/9/EC

- Ex II 1G EExia IIC T6 (Ta-20+/-40°C)  
TX (Ta-20+/-65°C)
- Ex II 1D tD A20 TX°C (Ta-20+/-40°C)  
TX°C (Ta-20+/-65°C)

For more information look up the EC-type examination, and documentation.  
 Consult for special requirements.

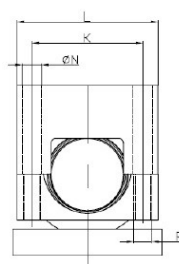
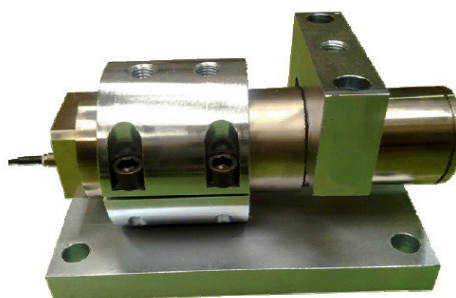

Recommended Loading Point

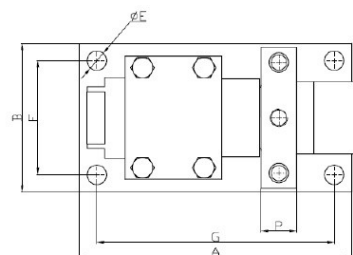
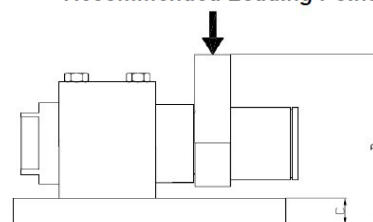

Dimensions in mm

Capacity	A	B	C	D	ØE	F	G	K	L	ØN	P	R
0,1 / 0,2 t	175	75	10	81	11	51	151	55	70	8,5	20	M8
0,5 / 1 / 2 t	204	100	15	107,5	12	76	180	75	100	11	20	M10

