

Model: CL-1

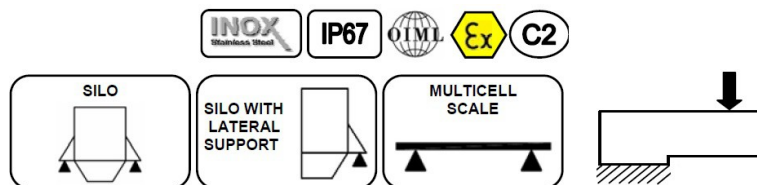

APPLICATION:
 High capacity and silos

CAPACITY RANGE:
 5t - 10t - 20t - 30t - 50t

MATERIAL:
 Stainless steel

ENVIRONMENTAL PROTECTION:
 IP67

APPROVALS:
 According to OIML - R60

CHARACTERISTICS
 Manufactured in stainless steel with IP67 protection.
 Mounting Kit in Stainless Steel or Zinc Steel.
 Hostile environmental cable. Mounting compatibility.

APPLICATIONS
 The CL-1 Model it's manufactured to maintain its characteristics in external environments. This model is applied to control silos of high capacity & replaces level indicators with more accuracy and reliability.

OPTIONS
 Length of the cable is optional.
 -10 to 100 °C temperature tolerance.

ATEX option EC-Type examination certificate
 CEC 11 ATEX 040 X according directive 94/9/EC

- II 1G EExia IIC T6 (Ta-20÷+40°C)
- II 1D tD A20 TX (Ta-20÷+65°C)
- TX°C (Ta-20÷+40°C)
- TX°C (Ta-20÷+65°C)

For more information look up the EC-type examination, and documentation.
 Consult for special requirements.

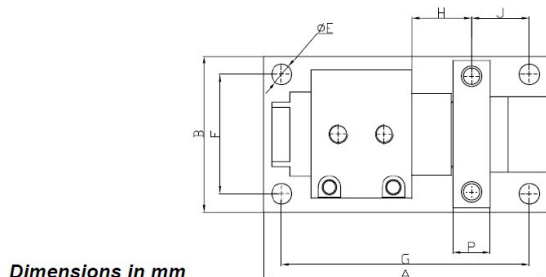
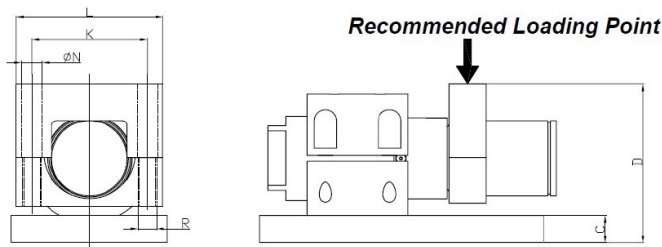
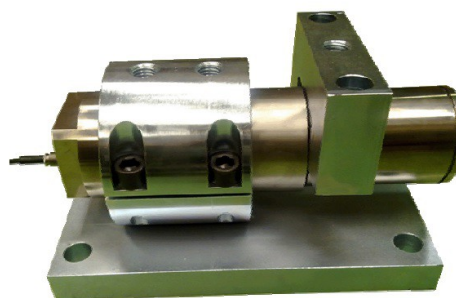

Dimensions in mm

Capacity	A	B	C	D	ØE	F	G	H	J	K	L	ØN	P	R
5 t	280	150	20	152	16	115	245	65	45.5	115	150	18	30	M16
10 t	310	170	30	173	22	130	270	65	63	126	160	22	40	M20
20 t	340	180	40	199	25	140	300	65	71	146	190	25	50	M24
30 t	340	180	40	199	25	140	300	65	71	175	220	26	53	M24
50 t	480	280	60	315	33	220	420	75	108	240	300	26	70	M24

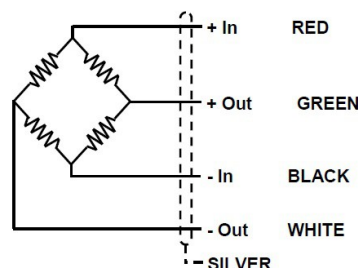

Model: CL-1

GENERAL TECHNICAL CHARACTERISTICS FOR g= 9,8031 m/ s2		
OIML Class	C2	UNITS
Divisions nLC	2000	
Minimum Dead load Emin	0	kg
Z= Emax / 2DR	2000	
Combined error	0,03	± % of NL
Rated Capacity Emax	5, 10, 20, 30, 50	tons
Repetability	0,01	± % of NL
Security Overload	100	± % of NL
Maximum Overload	200	± % of NL
Lateral Load	100	± % of NL
Rated Input Voltage	10	V dc/dc
Input Voltage Range	5..15	V dc/dc
Input Resistance R _{LC}	350 ± 5	Ω
Output Resistance	350 ± 5	Ω
Sensibility	2	mV/V
Output without load	1	± % of NL
Nominal Output	0,1	± % of value
Creep NL (30 min.)	0,04	± of load
Temperature Range : Compensated	-10 ... 50	°C
: Operating	-30 ... 85	°C
: Storage	-30... 90	°C
Max Temperature effect : On Sensitivity	0,0015	% Emax / °C
: On Zero	0,003	% Emax / °C
Cable Length	10	m
Cable features	<ul style="list-style-type: none"> - Teflon-insulated conductors - Shield with tinned copper braid 95% - PVC cover black and 7mm diameter - Operating temperature -15 ° + 80 ° - Bending radius 15Xd 	
Environmental Protection	IP67 - DIN 40050	