

Model: CFSIF

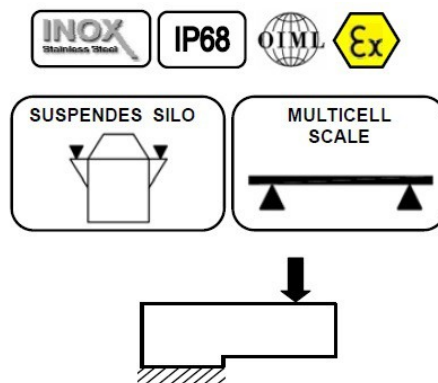

APPLICATION:
 Multi cell scales

CAPACITY RANGE:
 15kg - 25kg - 30kg - 50kg - 75kg - 100kg - 150kg
 300kg - 500kg - 750 kg - 1000kg - 1500 kg

MATERIAL:
 Stainless Steel

ENVIRONMENTAL PROTECTION:
 IP68

APPROVALS:
 According to OIML R60

CHARACTERISTICS
 Construction using stainless steel. The laser soldered closing protects from the typical environment in food and chemical industry.
 Mounting compatibility.

APPLICATIONS
 The CFSIF model is manufactured to maintain its performance capabilities in the environmental conditions existing in industries, where tasks and cleaning demand a good environmental protection.

OPTIONS
 Length of the cable is optional.
 Hostile environmental cable. ATEX option
 EC-Type examination certificate
 CEC 11 ATEX 040 X according directive 94/9/EC
 Ex II 1G EExia IIC T6 (Ta-20÷+40°C)
 TX (Ta-20÷+65°C)
 Ex II 1D tD A20 TX°C (Ta-20÷+40°C)
 TX°C (Ta-20÷+65°C)

For more information look up the EC-type examination, and documentation.
 Consult for special requirements.



TEFLÓN® protects all the internal cables

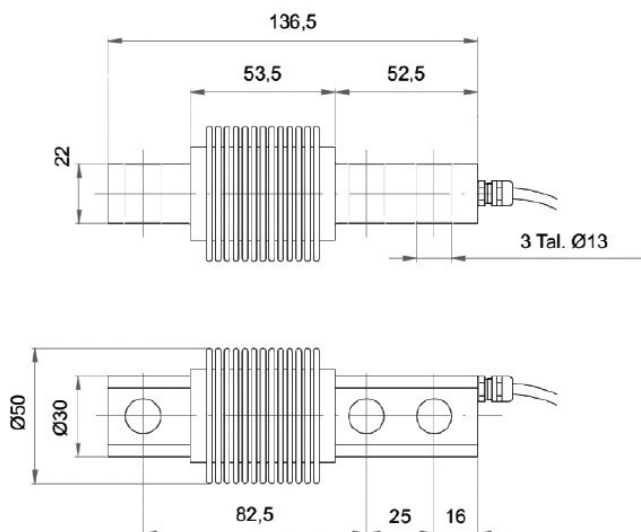

Dimensions in mm

